



Penny & Giles
Conductive Plastics Limited
Rotary Products Division

Advance Factory 36
Cwmfelinfach Gwent
NP1 7HZ United Kingdom
Telephone: (0495) 200860
Telex: 498015 Fax: (0495) 200805

A member of the
Penny & Giles Blackwood group of companies

SPECIFICATION

CUSTOMER: General.....

SPECIFICATION: No: D.20,873..... Rev: 3.....

DATE: 12th April, 1978.....

Directors
R W G Rice OBE (Chairman)
T M S Jones (Managing)
K N Hillman (Manufacturing)

Company Secretary
T S S I. Gower

Registered in England number 2097629
Registered office as above



SPECIFICATION

D. 20873

DESCRIPTION	Rotary Conductive Plastic Potentiometer Type RCP 05/1E
RESISTANCE \pm 10%	5000 ohms.
ELECTRICAL ANGLE \pm 2°	340°
LINEARITY INDEPENDENT	Grade D \pm -0.50% Grade E \pm -1.0% Grade N \pm -0.35%
RESOLUTION	Virtually Infinite
POWER DISSIPATION	1 watt @ 20°C
INSULATION at 500 VDC	100 M ohms. min.
TEMPERATURE RANGE	-65°C to + 130°C
MECHANICAL ANGLE	360°
STARTING TORQUE	5 gm. cm. max.
SHAFT RUN OUT inches T I R	0.001
LATERAL RUN OUT inches T I R	0.002
PILOT RUN OUT inches T I R	0.001
SHAFT END PLAY inches	0.003 max.



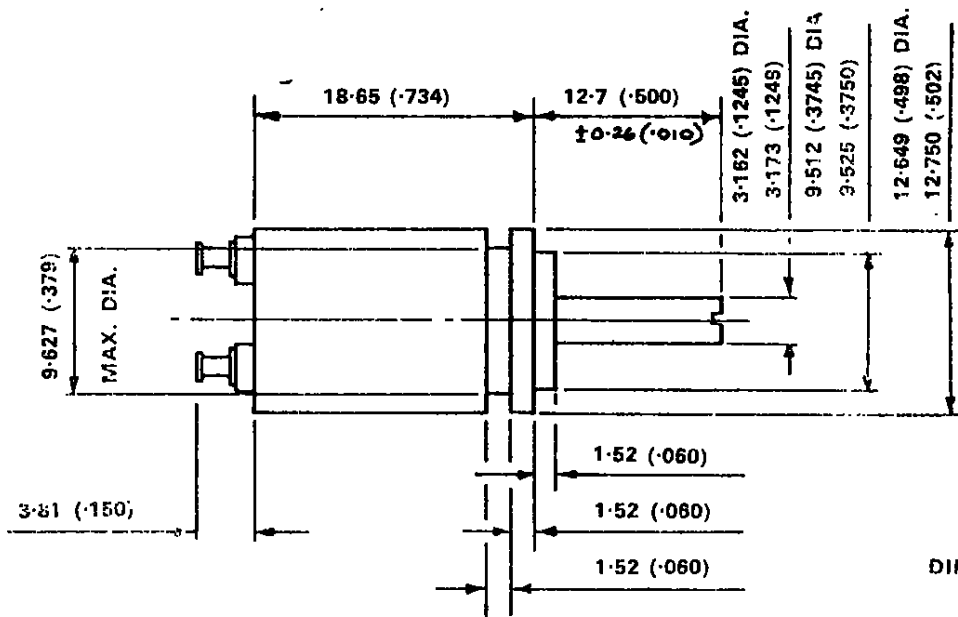

DIMENSIONS IN mm. (ins.)

WIRING DIAGRAM.

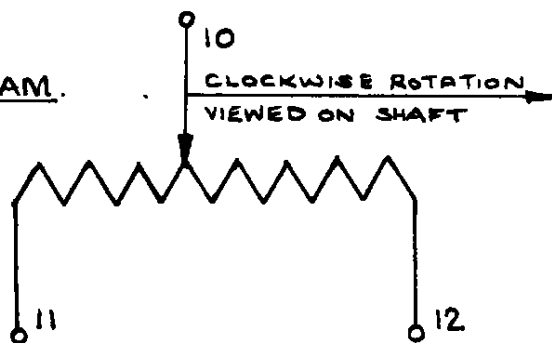

Test Certificate and Record of Revisions

SPECIFICATION.

Prepared by. *M. G.*..... Date... *12.4.78*..

Approved by. *J. Kirby*..... Date... *6.6.78*.....

REVISION	Changes	Checked	Date
1	New Issue	<i>J. Kirby</i>	<i>6.6.78</i>
2	<i>Linearity graded</i>	<i>M. Reese</i>	<i>17.4.84</i>
3	<i>Grade 'E' added.</i>	<i>M. Reese</i>	<i>26.9.84</i>

