

Data for installation and operation

Dimensions

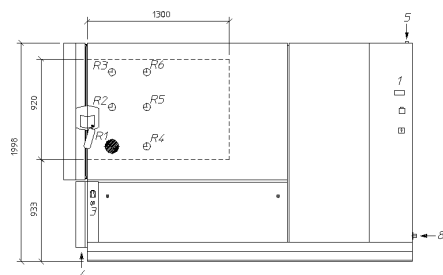

Test space

1100 mm wide
1300 mm deep
920 mm high

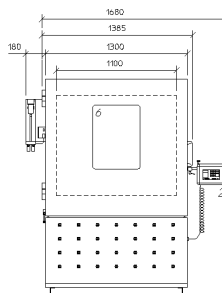

Cabinet (required space)

1385 mm wide
3205 mm deep
1980 mm high

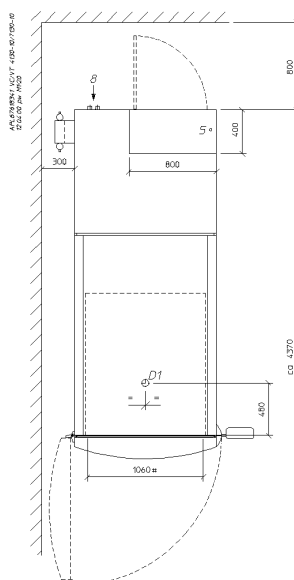
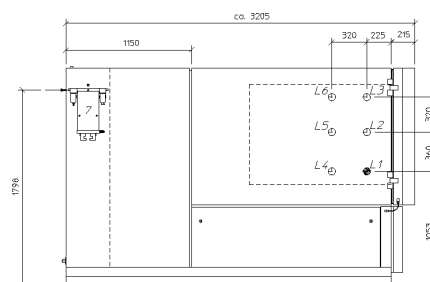

- Entry port installed in basic version
R1: NW 125 mm
L1: NW 50 mm
R2... additional installation positions r.h. side(option)
L2... additional installation positions l.h. side (option)
D1 Installation position in the ceiling (option)

- 1) Main switch panel
 - 2) Operator device >touch panel<
 - 3) Connector panel
 - 4) Connection for overflow and condensate drain
 - 5) Electrical connection, cable length approx. 3.5 m
 - 6) Door with window (option)
 - 7) Compressed-air dryer (option)
 - 8) Cooling water connection
- # Distance between shelf supports